

SARGENT®

ASSA ABLOY

degree[®]

Degree[®] Key System



Table of Contents

Degree® Key System

SARGENT®

ASSA ABLOY

Table of Contents

The Degree® Advantage	1
Specifications & Features	2
System Administration	3
Mortise Cylinders	4
Cams for Mortise Cylinders.....	5
Rim Cylinders	6
Large Format Interchangeable Core Mortise Cylinders	7-8
Large Format Interchangeable Core Rim Cylinders	9
Cylinders for Bored Locks	10
Cylinders for Deadbolts & Padlocks & Cylinder Finishes	11
6300 Series DG- Conversion Parts, Slide Block Kit & Shear Tool.....	12
Degree® Pin Kits	13
Rosettes & Collars.....	14
Visual Key Control Tamper Proof Packaging.....	15
Key Blanks/Key Sections.....	16
Master Keying & Cylinder Terms.....	17
Construction Master Keying (21- Option).....	18
KeyWizard™ Key Management Software	19
Architectural Specifications	20
Degree® System Information Document Explanation	21
Degree® System Information Document	22

Copyright © 2011, 2014 -2017, Sargent Manufacturing Company, an ASSA ABLOY Group company. All rights reserved.
Reproduction in whole or in part without the express written permission of Sargent Manufacturing Company is prohibited.

On The Cover

Degree Mortise Cylinder, Degree Key
and Degree 6300 Series Core

90705K 03/01/17

1-800-727-5477 • www.sargentlock.com

ASSA ABLOY, the global leader in door opening solutions

The Degree Key System

The patented Degree system from SARGENT provides the right level of security for each opening in your facility. Three levels of ANSI/BHMA Grade 1 protection, from patented keyway to UL437 certified, secures every opening. A common key for all three levels of security enhances key control and simplifies administrative procedures. Key blanks are controlled through authorized distribution and geographical protection is available. Available for mortise, rim, component and Large Format Interchangeable Core (LFIC) cylinders, SARGENT offers the right Degree of protection for every door in your facility.

Benefits

- Patent protection from unauthorized key duplication through 2027
- New keyway family protects system integrity from legacy systems
- Keys are significantly stronger than competitive systems
- User-friendly design with minimal components provides easy field service
- Availability in all existing SARGENT cylinder types provides cost-effective upgrade for SARGENT facilities
- Bump resistance for added protection

Degree Level 1 (DG1) features a utility patented keyway and provides protection against bumping for mortise, rim and component fixed cylinders. These cylinders easily retrofit into existing hardware and are appropriate for most applications. The keys for DG1 can only open DG1 cylinders.

Degree Level 2 (DG2) builds on the utility patented keyway of DG1 and adds patented side bar locking with unique angled bottom pins that provide end users with geographical exclusivity. Cylinders provide protection against bumping and picking. Because of its superior key control and patent protection until 2027, DG2 products are recommended for use in conjunction with DG3 for new installations or when retrofitting systems, including large format interchangeable core systems.

Degree Level 3 (DG3) combines the utility patented keyway and side bar locking with unique angled bottom pins that provide end users with geographical exclusivity, and adds certification to UL437. They are classified as high security because of their superior resistance to physical attack and protection against unauthorized key duplication. Because of its superior key control, patent protection until 2027, and physical strength, we recommend DG3 products for new high-security installations or when retrofitting systems, including large format interchangeable core systems. SARGENT also offers anti-vandal and high security locksets that complement DG3 cylinders for those openings most vulnerable to attack.

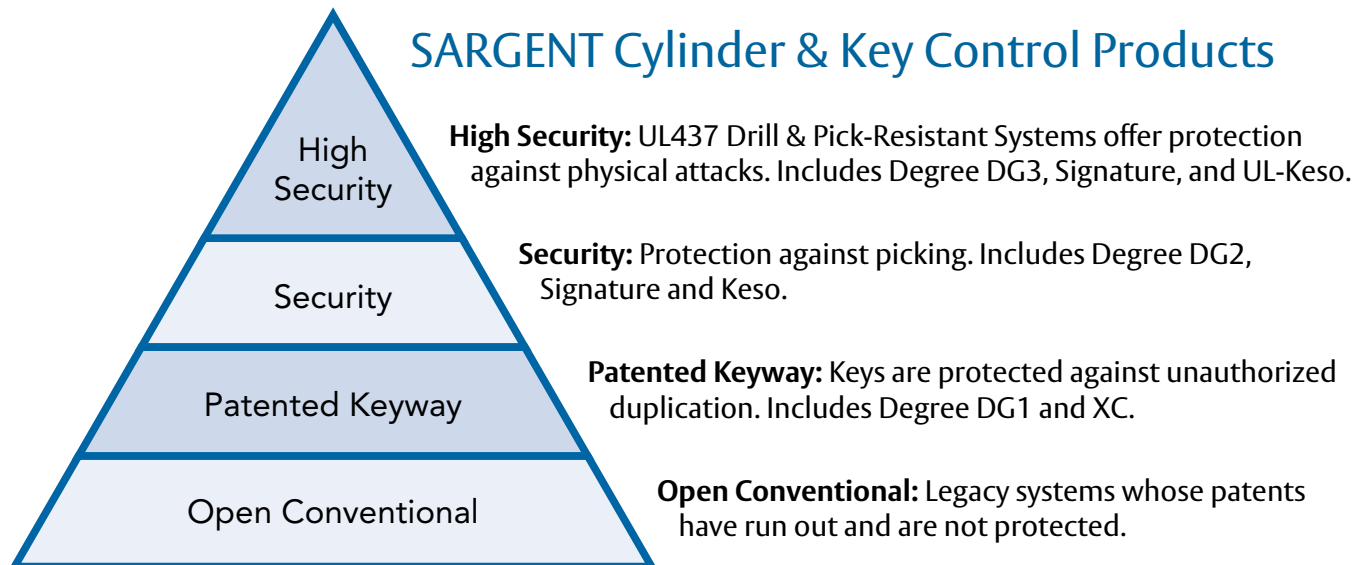

Specifications & Features

Degree® Key System

SARGENT®

ASSA ABLOY



Features of the Degree Key System

	DG1	DG2	DG3
Utility patented until 2027	X	X	X
Key blank distribution restrictions	X	X	X
Geographic exclusivity		X	X
Bump resistant	X	X	X
Common style pins	X		
Unique angled bottom pins		X	X
Convenient, simple to service	X	X	X
New keyway family and keying specifications from previous SARGENT systems	X	X	X
Can be masterkeyed with all Degree levels and LFIC	X	X	X
Certified to UL437			X

Product Specifications

All cylinders shall be utility patented, bump resistant and require the use of a patented key. All cylinders shall be available in any of the mortise, rim, key-in-knob/lever, auxiliary locks, padlocks or large format interchangeable core types.

Degree offers three distinct security options from which facilities can select the appropriate degree of security for any door. Degree's one-key design allows the use of all three locking mechanisms within the same system to be operated with just one key. Degree provides the ultimate in key control by simplifying ordering processes and by allowing the system administrator to determine the level of protection for system components. Additional specifications are found on page 20.

Keying Specifications

Keying

- Degree is a factory-based key system
- 6 pin cylinders furnished with two nickel silver keys per cylinder. Degree cylinders may be furnished uncombined, master keyed, or grandmaster keyed to a specific facility. Double cylinder lock sets keyed alike on both sides will get two change keys total
- Degree's one-key design allows the use of all three locking mechanisms within the same system to be operated with just one key
- Degree systems are independent and cannot be keyed into existing and/or conventional SARGENT master key systems
- Cross keying is not recommended. Keying Department Administration will review all requests and determine if compatible with a secured master key system

UL 437 Listed Cylinders

SARGENT DG3 cylinders* are UL437 Listed. UL437 sets the standard for both drilling and picking resistances.

These cylinders are manufactured to include hardened drill resistant inserts in both the plug/barrel and body.

UL437 High Security DG3 cylinders are recommended for doors most likely to be physically assaulted, while the use of standard DG1 and DG2 cylinders is more advantageous and less costly for interior doors.

* **Note:** DG3 cylinder offerings include mortise, rim and bored cylinders in conventional as well as Large Format Interchangeable Core

Patent pending and/or patent www.assaabloydss.com/patents

Product Certifications

ANSI/BHMA A156.5-2010 Grade 1

E09211 (Mortise)

E09221 (Rim)

E09231 (Bored Lock Cylinders)



Applications

Degree is recommended for installations requiring patented key control protection including protection from picking and/or drilling, all available in one locking system. Degree is ideally suited for Educational and Healthcare facilities, Industrial and Commercial buildings.

Copyright © 2011, 2014-2017, Sargent Manufacturing Company, an ASSA ABLOY Group company. All rights reserved. Reproduction in whole or in part without the express written permission of Sargent Manufacturing Company is prohibited.

90705K 03/01/17

Degree System Administration

All SARGENT Degree key systems must have a signed System Information Document (SID), located in the back of this catalog and available online, for each facility. The SID designates a primary systems administrator for the facility. Unless otherwise indicated by the primary systems administrator by way of a separate specific letter of authorization, all shipments for Degree product will go to the shipping address on the Systems Information Document.

All key blanks are to remain in the possession of the facility and must be accounted for. Any defective, incorrectly cut or damaged key blanks must be destroyed.

For Degree DG2 and DG3, specific randomized security codes will be required for each order unless the systems administrator opts out of this feature. For more information, see the Systems Information Document.

Keyway Administration and Assignment

All keyways will be noted on the master key system biting list. SARGENT Keying Department Administration will assign all DG keyways. Keyways will be assigned according to facility type, geographic location and keying system specifications. All keys will ship directly to the end user. All master key systems will be registered with Keying Department Administration and all bittings will be factory created.

Key Control

Key control will be maintained by using the SARGENT Keying Authorization Document. For a copy, contact Keying Department Administration or visit our web site at www.sargentlock.com. System information and/or systems related product will be forwarded directly to the owner, unless otherwise indicated by the owner's appointed administrator.

Authorized Distributors

SARGENT Degree is a system-based product and is provided through authorized distribution. An authorized distributor may stock and service products upon specific written authorization from the primary system administrator of the facility.

Authorized distributors who carry inventory for a specific facility's system must provide valid receipts and disbursements of all products, specifically key blanks/cut keys. All key blanks in the possession of an authorized distributor must be accounted for. Any defective, incorrectly cut or damaged key blanks must be destroyed.

Refer to pages 21 and 22 for a copy of the SID and more information.

Mortise Cylinders

Degree® Key System

SARGENT®

ASSA ABLOY

DG1-, DG2- & DG3- Series Mortise Cylinders

For use with Mortise Locks, Exit Devices and Auxiliary Locksets



Mortise Fixed Core (FC)

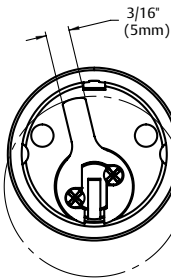
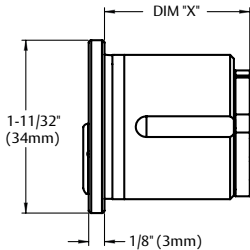

SARGENT standard cam shown

Standard Degree Mortise Cylinders supplied with:

- Solid brass, 6 pin cylinder, 1-5/32" (29mm) diameter
- TA keyway standard – see page 16 for available keyways
- No. 97 rosette and compression spring, when hardware is ordered less cylinder
- Offset cam DG-0001 standard – see available cams on page 5
- Factory keyed

Options

- Construction Master Keying (21- option)
 - Allows use of construction keys until change key voids operation
 - Ships with 6 master construction keys separate from change keys
 - Removable Disposable Construction Core (60- option)
 - Operate with coin or flat screw driver
 - Easy installation
 - Removable Core (63- option)
 - Control key releases locking cam for removal of core
 - 2 control keys furnished standard
 - Removable Construction Keyed LFIC (64- option)
 - Furnished with 6 keys and 1 control key standard
 - Plug face dimpled for easy identification
 - Unassembled/Uncombined Cylinder (65- Option)
 - DG1 and DG2 only
 - Includes two key blanks but no pins, springs or slide
 - When ordered with hardware, 65-DG cylinders are packed uninstalled with hardware
 - Available on existing systems only
- § DG2 & DG3 cylinders are not available as Hotel function (50-)
- Exposed Plug only (78- option)
 - Exposed plug .560" (14mm) diameter
 - For use with trim LE3/LE4 & KE3/KE4; specify 78- only when cylinder is ordered less product
 - Supplied with standard offset cam DG 0001; optional cam 105 for use on inside of 7816/8216/9200 locks only
 - Hotel function§
 - 7850 or 8250 hotel function mortise locks require a 50- cylinder where change keys and master keys have limited rotation that only allow latch bolt retraction
 - #115 cam supplied standard with 50 function hotel locks & cylinders
 - The #115 cam is supplied only with SARGENT 7850/8250 locks
 - Guest and Master keys will only retract the latch bolt but not project or retract the dead bolt
 - Emergency keys, ordered separately, retract or project the latchbolt and deadbolt (p/n DG7268 EMK)
 - Available in #43 (1-3/8") and #44 (1-1/2") cylinder lengths
 - Hotel function available with Large Format Interchangeable Core (63-), Plastic Disposable Temporary Core† (60-) & Construction Core‡ (64-)
- ‡ Note: 60- & 64- will retract Latch only, it will not retract the deadbolt

Length under cylinder head

Cylinder No.	41	42	43	44	46
DIM "X"	1-1/8" (29mm)	1-1/4" (32mm)	1-3/8" (35mm)	1-1/2" (38mm)	1-3/4" (44mm)

Degree Mortise Cylinders

Type	Degree Level	Cylinder Size	Cam(s)
Degree Mortise Cylinders	DG1-, DG2- or DG3-	41 (1-1/8"); 42 (1-1/4"); 43 (1-3/8"); 44 (1-1/2"); 46 (1-3/4")	Std, 101, 104, 105, 106, 112 & 113
Exposed Plug DG Mortise Cylinders (Specify 78-)	DG1-	41 (1-1/8"); 42 (1-1/4"); 43 (1-3/8")	Standard or 105
Hotel Function DG Mortise Cylinders (Specify 50-)	DG1-	43 (1-3/8"); 44 (1-1/2")	115 only

How to Order DG Series Mortise Cylinders less hardware

Quantity	Options*	Cylinder Size	Cam	Key Set	Door#/Item#	Finish†
75	DG1-	41	Std	AA1		26D

* Available options for Degree Mortise Cylinders are: DG1-, DG2-, DG3-, 21-, 50-, 60-, 63-, 64-, 65- & 78-

How to Order DG Series Cylinder with Hardware (8200 Mortise example)

Quantity	Options**	Series & Function	Rose/Escutcheon	Lever	Finish†	Hand	Keying Detail
95	DG3-	8205	LN	MX	15	RH	AA1

** Available options for Degree Mortise cylinders ordered with hardware are: DG1- DG2-, DG3-, 21-, 60-, 63-, 64- & 65- (78- cylinders are determined by the function or trim specified and are not specified when ordering)

† Finishes available: 03, 04, 09, 10, 10B, 10BE, 10BL, 14, 15, 20D, 26, 26D

Cams for Mortise Cylinders

Degree® Key System



SARGENT®

ASSA ABLOY

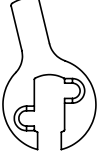
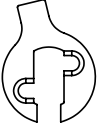
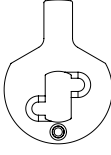
Cams For Degree Mortise Cylinders* in SARGENT Keyways

 <p>Standard Cam (DG-0001)</p> <p>Standard open slotted cam provided on all 40 Series -standard. Except: 16 & 92 function Mortise Locks</p>	 <p>Short Cam (-105) (DG-0002)</p> <p>Cam used with SARGENT mortise functions 16 & 92 on the inside cylinder</p>	 <p>Hotel Cam (-115) (DG-2808)</p> <p>Cam only offered on limited rotation hotel function cylinder for use in 78/8250 lock sets</p>
---	--	---

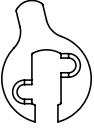
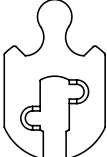
Miscellaneous Cams*

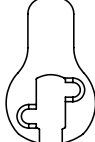
 <p>Adams Rite (-101) 1850, 4700 (DG-0004)</p>	 <p>SARGENT 4370 Series Key Switches (-113) (DG-0006)</p>	 <p>Schlage "L" (-106) (DG-0007)</p>	 <p>Misc. Cam (-112) (DG-0008)</p>
--	---	--	--

* Order cam screws as DG-0016, if needed.
Cams are unique to DG cylinders and standard SARGENT cams are not compatible

Cams for DG-60-63-64- Large Format Interchangeable (Removable) Core Mortise Cylinders

- 6300 Cams are factory installed and are not removable
- 6300 Cams are not sold separately
- Specify cam as a suffix: DG1-63-44 x 105 cam
- For Standard Cam: No Suffix is required



Standard

6300 Series Cam



-105

Cam for inside cylinder of Mortise 16 & 92 function locks



-115

Cam for 6300 Series 50 function locks



-101

ADAMS RITE
1850 4710



-113

4370 Series
key switch



-106

Schlage
"L"



-112

Misc. Cam

Copyright © 2011, 2014-2017, Sargent Manufacturing Company, an ASSA ABLOY Group company. All rights reserved. Reproduction in whole or in part without the express written permission of Sargent Manufacturing Company is prohibited.

Rim Cylinders

Degree® Key System

SARGENT®

ASSA ABLOY

DG1-, DG2- & DG3- Series Rim Cylinders

For use with Exit Devices and Auxiliary Locking Devices



Rim Fixed Core

Standard Degree Rim Cylinders supplied with:

- Solid brass, 6 pin cylinder, 1-5/32" (29mm) diameter
- TA keyway standard – see page 16 for available keyways
- No. 97 rosette and compression spring, break-off screws and back plate
- Horizontal tail piece only
- 27/32" (21mm) screw pattern through-bolts to SARGENT exit devices (same as standard rim cylinders)
- Factory keyed

Options

- Construction Master Keying (21- option)
 - Allows use of construction keys until change key voids operation
 - Ships with 6 master construction keys separate from change keys
- Removable Disposable Construction Core (60- option)
 - Operate with coin or flat screw driver
 - Easy installation
- Removable Core (63- option)
 - Control key releases locking cam for removal of core
 - 2 control keys furnished standard
- Removable Construction Keyed LFIC (64- option)
 - Furnished with 6 keys and 1 control key standard
 - Plug face dimpled for easy identification
- Unassembled/Uncombined Cylinder (65- Option) – DG1 and DG2 only
 - Includes two key blanks but no pins, springs or slide
 - When ordered with hardware, 65-DG cylinders are packed uninstalled with hardware
 - Available on existing systems only

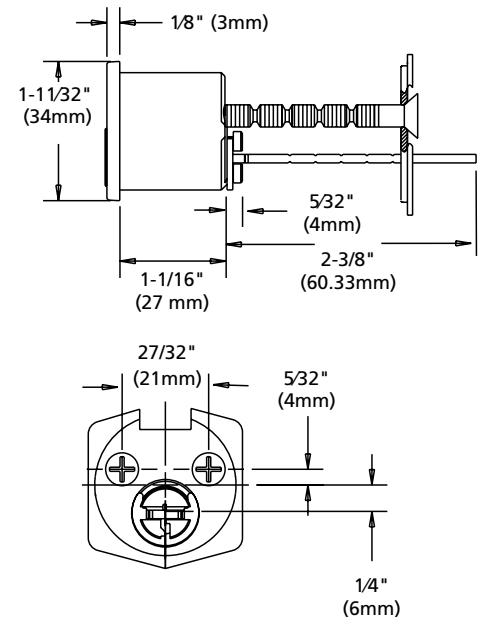

Degree Rim Cylinders

Type	Degree Level	Cylinder Type
Degree Rim Cylinders	DG1-, DG2- or DG3-	34 Rim Cylinder

How to Order DG Series Rim Cylinders less hardware

Quantity	Options*	Cylinder Type	Key Set	Door#/Item#	Finish†
75	DG2-	34	AA1		26D

How to specify DG Series Cylinder with Hardware (80 Series Exit Device example)

Quantity	Options*	Series & Function	Rail Size	Trim	Finish†	Hand	Keying Detail
25	DG2-	8804	F	ETL	32D	RHR	AA1

* Available options for Degree Rim Cylinders are: DG1-, DG2-, DG3-, 21-, 60-, 63-, 64- & 65-

† Finishes available: 03, 04, 09, 10, 10B, 10BL, 14, 15, 20D, 26, 26D

Copyright © 2011, 2014-2017, Sargent Manufacturing Company, an ASSA ABLOY Group company. All rights reserved. Reproduction in whole or in part without the express written permission of Sargent Manufacturing Company is prohibited.

90705K 03/01/17

Large Format Interchangeable Core Mortise Cylinders

Degree® Key System

SARGENT®

ASSA ABLOY

Degree Large Format Interchangeable Cores and Cylinders

For use with Mortise Locks, Exit Devices and Auxiliary Locksets



**DG-6300
Cylinder Core**

Core only (DG-6300):

- Solid brass, 6 pin cylinder
- Available in 04 or 15 finish only
- TA keyway standard – see page 16 for available keyways
- Factory keyed or available unassembled* for field keying (65-)
- Offset cam DG-0001 standard – see available cams on page 5
- Hotel functions (50-) available with DG1-
- Order core only as: DG1- 6300, DG2- 6300 or DG3- 6300

*65- option available for DG1 and DG2 only. Includes two key blanks but no pins, springs or slide. (Available on existing systems only)

Housings:

- Solid brass, 1-5/32" (29mm) diameter
- Available in finishes: 03, 04, 09, 10, 10B, 10BL, 14, 15, 20D, 26, 26D
- Furnished with no. 97 rosette and compression spring when supplied without hardware
- Available in 42 (1-1/4"), 43 (1-3/8"), 44 (1-1/2"), or 46 (1/34") lengths

Options:

Removable Disposable Construction Core (60- option)



**DG-60-Mortise
Housing**

- Mortise housing with disposable plastic core
- After removal of temporary plastic core, housing accepts DG-6300
- Operates with coin or flat screw driver
- Easy installation
- Order as: DG1-60- housing size x cam x finish
DG2-60- housing size x cam x finish
DG3‡-60- housing size x cam x finish

- Notes:**
- DG1 and DG2 use the same mortise housing
 - DG3 cores must be used with DG3 housings to maintain UL437 listing

- Hotel Functions
 - DG-60-Hotel function (50-) housings are available in DG1- only, in #43 (1-3/8") length and only for use in Sargent 78/8250 lock sets
 - Order as: DG1-60-50-43 x finish (Note: used with DG1-6300 cores only)
 - Emergency Master Key ordered separately, as an DG7269EMK

Removable Core (63- option)



**DG-63-Mortise
Cylinder**

- Mortise housing with DG LFIC
- Can be master or grandmaster keyed
- Control key releases locking cam for removal of core
- Available as unassembled less springs, pins and slide (65-)
- 2 control keys furnished standard
- Additional control keys for DG1 systems: DG6272CTL; control keys for DG2 and DG3 systems: DS6272CTL
- Order as: DG1-63- housing size x cam x finish
DG2-63- housing size x cam x finish
DG3‡-63- housing size x cam x finish

- Hotel Functions
 - DG-60-Hotel function (50-) housings are available in DG1- only, in #43 (1-3/8") length and only for use in Sargent 78/8250 lock sets
 - Order as: DG1-60-50-43 x finish (Note: used with DG1-6300 cores only)
 - Emergency Master Key ordered separately, as an DG7269EMK

Removable Construction Keyed LFIC (64- option)



**DG-64-Mortise
Housing with
Construction
Core**

- Mortise housing with construction core
- Construction cores are keyed alike in KA keyset
- After removal of construction core, housing accepts DG-6300
- Furnished with 6 keys and 1 control key standard
- Plug face dimpled for easy identification
- Order as: DG1-64- housing size x cam x finish
DG2-64- housing size x cam x finish
DG3‡-64- housing size x cam x finish

Large Format Interchangeable Core Mortise Cylinders

Degree® Key System

SARGENT®

ASSA ABLOY

How to order 6300 Series LFIC DG mortise cylinders less hardware

	Quantity	Options*	Cylinder Size	Cam	Keying Detail	Finish
Complete Cylinder: DG-LFIC and Housing	75	DG2-63-	44	Std	AA1	26D
Housing Only	125	DG1-60-	44	Std	-	26D
LFIC Only	85	DG2-6300	-	-	AA1	15

* Available options for Degree LFIC Mortise Cylinders are: DG1-, DG2-, DG3-, 50-, 60-, 63-, 64- & 65-

Note: Cores are available in 04 & 15 finish

How to Order DG Series 6300 Series LFIC Cylinder with Hardware (8200 Series Mortise Lock example)

Quantity	Options**	Series & Function	Rose/Escutcheon	Lever	Finish	Hand	Keying Detail
95	DG2-63-	8237	LE1	ML	26D	RHR	AA1

**Available options for Degree Mortise Cylinders are: DG1-, DG2-, DG3-, 60-, 63, 64- & 65-

Large Format Interchangeable Core Rim Cylinders

Degree® Key System



Degree Rim Large Format Interchangeable Cores and Cylinders

For use with SARGENT Mortise locks, Exit Devices and Auxiliary Locking Devices



DG-6300
Cylinder Core

Core only (DG-6300):

- Solid brass, 6 pin cylinder
- Available in 04 or 15 finish only
- TA keyway standard - see page 16 for available keyways
- Factory keyed or available unassembled* for field keying (65-)
- Horizontal tailpiece
- Supplied with backplate and 2 breakaway screws
- Order core only as: DG1- 6300, DG2- 6300 or DG3- 6300

Notes: • DG3 cores must be used with DG3 housings to maintain UL437 listing

*65- option available for DG1 and DG2 only. Includes two key blanks but no pins, springs or slide. (Available on existing systems only)

Housings:

- Solid brass, 1-5/32" (29mm) diameter
- Available in finishes: 03, 04, 09, 10, 10B, 10BL, 14, 15, 20D, 26, 26D
- Furnished with no. 97 rosette and compression spring when supplied without hardware
- Screw pattern same as standard rim cylinder
- Available in 42 (1-1/4"), 43 (1-3/8"), 44 (1-1/2"), or 46 (1/34") lengths

Options:

Removable Disposable Construction Core (60- option)



DG-60-Rim
Housing

- Rim housing with disposable plastic core
- After removal of temporary plastic core, housing accepts DG-6300
- Operates with coin or flat screw driver
- Easy installation

- Order as: DG1-34-60- x finish
DG2-34-60- x finish
DG3‡-34-60- x finish

Removable Core (63- option)



DG-63-Rim
Cylinder

- Rim housing with DG LFIC
- Can be master or grandmaster keyed
- Control key releases locking cam for removal of core
- Available as unassembled less springs, pins and slide (65-)
- Control keys furnished standard
- Additional control keys for DG1 systems: DG6272CTL; control keys for DG2 and DG3 systems: DS6272CTL

- Order as: DG1-34-63- x finish
DG2-34-63- x finish
DG3‡-34-63- x finish

Removable Construction Keyed LFIC (64- option)



DG-64- Rim
Housings with
Construction
Core

- Mortise housing with construction core
- Construction cores are keyed alike in KA keyset
- After removal of construction core, housing accepts DG-6300
- Furnished with 6 keys and 1 control key standard
- Plug face dimpled for easy identification

- Order as: DG1-34-64- x finish
DG2-34-64- x finish
DG3‡-34-64- x finish

How to order 6300 Series LFIC DG rim cylinders less hardware

	Quantity	Options*	Cylinder Type	Keyset	Finish
Complete Cylinder: DG-LFIC and Housing	200	DG2-63-	34	AA1	26D
Rim Housing Only	175	DG1-60-	34	-	26D
LFIC Only	95	DG2-6300	-	AA1	15

* Available options for Degree Rim Cylinders are: DG1-, DG2-, DG3-, 60-, 63-, 64-, 65-

Note: Cores are available in 04 & 15 finish

How to Order LFIC DG Series Rim Cylinder with Hardware (80 Series Exit Device example)

Quantity	Options**	Series & Function	Rail Size	Trim	Finish	Hand	Keying Detail
50	DG2-63-	8804	F	ETL	32D	LHR	AA1

** Available options for Degree Rim Cylinders are: DG1-, DG2-, DG3-, 60-, 63-, 64-, 65-

Cylinders for Bored Locks

Degree® Key System

SARGENT®

ASSA ABLOY

Fixed Core Component

For use with SARGENT Cylindrical Lever, Knob Locks and Auxiliary Locksets



Key-in-knob (KIK),
Key-in-lever (KIL)
Fixed Core (FC)

How to Order DG Series Lever & Knob Cylinders less hardware

Quantity	Degree Level	Catalog No	Keyway	Finish**
75	DG1, DG2 or DG3	C10-1	TA	04

- Furnished factory keyed and only DG1 and DG2 are offered with the 65- option of unassembled for field keying. 65- cylinders include two key blanks but no pins, springs or slide

** Available in 04 and 15 finishes only

Options

- Construction Master Keying (21- option)
 - Allows use of construction keys until change key voids operation
 - Ships with 6 master construction keys separate from change keys
- Unassembled/Uncombined Cylinder (65- Option) – DG1 and DG2 only
 - Includes two key blanks but no pins, springs or slide
 - When ordered with hardware, 65-DG cylinders are packed uninstalled with hardware
 - Available on existing systems only

Designations & Options for Degree Series Components

SARGENT Lockset		Degree Level	Catalog No	Finish	Function
11 Line Locks		DG1, DG2 or DG3	C11-1	US 04 or US 15	All functions except 50 function
		DG1	C11-2	US 04 or US 15	Hotel function (50-)
10, 7, 7500* Line (Levers) & 6500 Locks & 88KL, 88CL, 28KL, 28NL & 28CL Exit Trims		DG1, DG2 or DG3	C10-1	US 04 or US 15	All functions except 50 function
		DG1	C10-2	US 04 or US 15	Hotel function (50-)
7*, 8* & 9* Line Knob Locks		DG1, DG2 or DG3	C8-1	US 04 or US 15	All functions except 50 function
		DG1	C8-2	US 04 or US 15	Hotel function (50-)
8X Line Cylindrical Knob Locks		DG1, DG2 or DG3	C8X-1	US 04 or US 15	
6 Line Cylindrical Locks		DG1, DG2 or DG3	C6-1: S&M Knob C6-1B: B Knob	US 04 or US 15	
7600 Integralock*		DG1, DG2 or DG3	C7600-1 for functions 04, 05, 37	US 04 or US 15	

Note: All cylinders supplied with two change keys; for lock functions that have two cylinders keyed alike, only two change keys will be provided

* Discontinued products

Hotel Functions (50) are not available with 9 Line knobs, 7 Line levers, 7500 Interconnected, 6500 Locks, & Exit Trims.

Emergency key to be ordered separately for bored locks as DG6267EMK

Copyright © 2011, 2014 -2017, Sargent Manufacturing Company, an ASSA ABLOY Group company. All rights reserved. Reproduction in whole or in part without the express written permission of Sargent Manufacturing Company is prohibited.

90705K 03/01/17

Cylinders for Deadbolts & Padlocks & Cylinder Finishes

Degree® Key System



Bored Auxiliary Deadlocks

For use with Bored Auxiliary Deadlocks

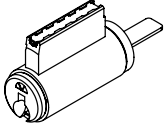
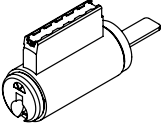
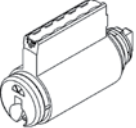
SARGENT Lockset		Degree Level	Catalog No	Finish	Function
460* Series Deadbolt		DG1, DG2 or DG3	C460-1	US 04 or US 15	464
		DG1, DG2 or DG3	C460-2	US 04 or US 15	465
450*, 470, 480 Series Deadbolts		DG1, DG2 or DG3	C480-1	US 04 or US 15	454, 474, 484
		DG1, DG2 or DG3	C480-2	US 04 or US 15	455, 475, 485, 487
		DG1, DG2 or DG3	C480-3	US 04 or US 15	456, 486
758 & 858 Padlocks		DG1, DG2 or DG3	C750-1	US 04 or US 15	758 and 858 padlocks

Note: All keyed cylinders supplied with two change keys. For lock functions that have two cylinders keyed alike, only two change keys will be provided

- Only DG1 and DG2 are offered with the 65- option of unassembled for field keying. 65- cylinders include key blanks but no pins, springs or slide
- When hardware is ordered with 65- cylinders, it will ship uninstalled with hardware

Finishes available for Mortise and Rim Cylinders°

SARGENT Code	ANSI/BHMA Code	Finish Description
03	605	Bright Brass, clear coated
04	606	Satin Brass, clear coated
09	611	Polished Bronze, clear coated
10	612	Satin Bronze, clear coated
10B	613	Satin Bronze, oxidized and oil rubbed
10BE	613E	Dark Oxidized Satin Bronze - Equivalent
10BL	614	Satin Bronze, oxidized and clear coated
14	618	Bright Nickel
15	619	Satin Nickel
20D	624	Statuary Dark Bronze, clear coated
26	625	Bright Chrome Plated
26D	626	Satin Chrome Plated

°Key-in-knob/Key-in-lever and LFIC are available 04 and 15 finishes only

Note: 32 & 32D finished hardware will be supplied with 26 & 26D finished cylinders accordingly

* Discontinued products

6300 Series DG- Conversion Parts, Slide Block Kit & Shear Tool

Degree® Key System

SARGENT®
ASSA ABLOY

SARGENT 6300 Series Housings and KIL/KIK Locks

Older 6300 series mortise and rim cylinders with long pins in the housings will need to be modified to accept 6300 Series DG- cores.

KIL/KIK lock sets with removable tail pieces will require new tail pieces as shown below.

6300 Series DG- Conversion Parts for #34 rim cylinders, 8-Line knob locks and 480 Series deadbolts

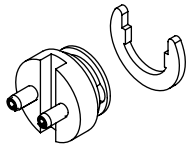

Kit # 13-5178 is used to convert rim cylinders with long pins to accept 63-DG Series cores and 11-63-series cores

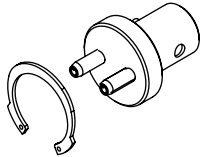

Kit # 08-5265 for DG-63-Series and 11-63-8-Line knobs

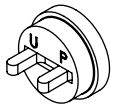

Kit # 16-2508 for DG-63-Series and Cam Assembly for 11-63-Deadbolts

6300 Series DG- Conversion Parts for 758/858 Padlocks, 11 Line (T-Zone), 10, 7, 6500 Line

Note: Only existing 6300 cores with removable tailpieces can be upgraded to Degree without modifying the lock

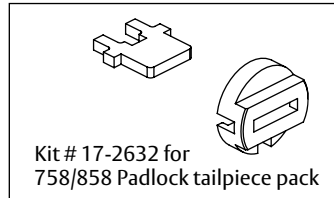

Kit # 17-2632 for 758/858 Padlock tailpiece pack

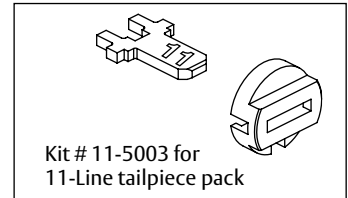

Kit # 11-5003 for 11-Line tailpiece pack

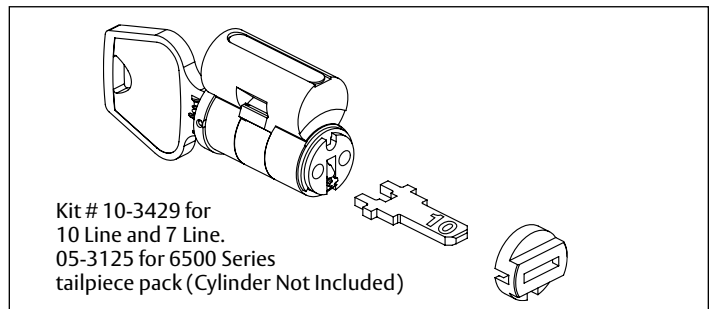

Kit # 10-3429 for 10 Line and 7 Line. 05-3125 for 6500 Series tailpiece pack (Cylinder Not Included)

431-6 Shear Tool

- 431-6 Shear Tool is used to alter older SARGENT 60-/63- mortise housings to accept 6300 Series DG cores and 11-6300 series cores.
- Altered housings will accept 6300 DG1-, DG2- and DG3- cores.

Note: DG3- cores with altered housings are not UL437 listed, DG3 cores require DG3 housings to be UL437 listed

- For 6300 rim cylinders use Kit #13-5178

436-1 Slide Block Kit

- Includes fixture and staking tool for use with all DG- 6300 cores, and 11- and 10- 6300 series cores manufactured after March 2006 and standard cylinders manufactured after May 2008, simplifying top loading in the field.
- The kit includes:
 - 100 slides
 - staking block
 - staking tool
- Cylinders manufactured after March 2006 will not include the box around the SARGENT logo and can be used with this kit.
- Additional slides available:
 - 7 pin slides (Part # 13-1797)
 - 6 pin slides (Part #13-1341)

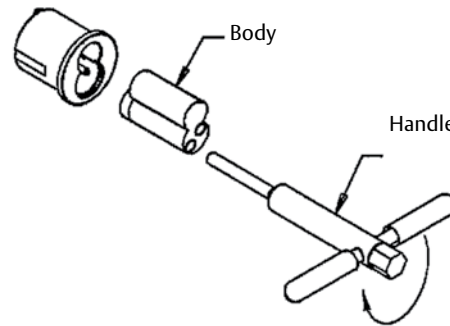
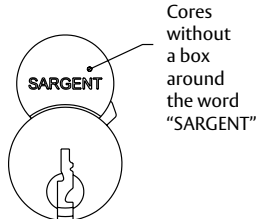
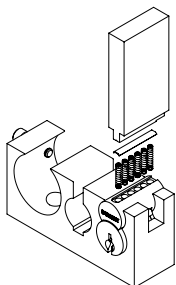

6300 Large Format Interchangeable Core Installation Tool (432 RC)



- The 432 RC is a tool to assist in installing SARGENT Large Format Interchangeable (Removable) Core Mortise Housings. This tool makes it easy to thread a cylinder body into a mortise lock and can also help check the cylinder function in a lock before installing the cylinder core
- Order: 432 RC for the SARGENT Large Format Interchangeable (Removable) Core Installation Tool

437 DG1 Standard Pinning Kit

The 437 DG1 Kit is used to pin DG1 fixed and LFIC cylinders. The heavy duty steel kit prevents pins from mixing.

The kit includes:

100 each of bottom pins sizes 1-6

- 100 each of control drivers sizes 1-11
- 100 each of driver pins sizes 1-9
- 100 each of bump resistant pins sizes 4-9
- 25 sidebar springs part number DG-0059
- 100 KIK spring cover part number 13-1341
- 25 KIL/MRT/RIM/LFIC spring cover DG-0040
- 10 each Sidebar (LFIC only) part number DG-2818
- 100 each compression spring part number DG-0017
- 100 each compression spring (LFIC only) part number DG-0097
- Tweezer
- Degree key gauge

See pages 2 and 3 in the Technical Manual for individual pin part #s.

The kit has additional empty compartments for future upgrades to DG2 and DG3 cylinders.

The 437 DGM "Master Kit" has all pins needed for pinning DG1, DG2 and DG3 cylinders.



437 DGM Master shown

437 DGM Master Pinning Kit

The 437 DGM "Master Kit" includes all pins needed to re-pin DG1, DG2 and DG3 cylinders.

Kit includes all the same components as in the 437 DG1 kit, with the additional parts to service DG2 and DG3 cylinders.

10 each Side bar part number DG 0056

- 25 each slider spring part number DG 0060
- 100 each of Left, Center and Right "Chisel Bottom Pins" sizes 1 thru 6

See pages 2 and 3 in the Technical Manual for individual part numbers.

Cylinder Spray Lubricant

Degree cylinders are mechanical devices and require preventive maintenance. At a minimum, Degree cylinders should be lubricated twice a year; more if installed in extreme installations.

Degree cylinders should not be exposed to chemical washes or painted.

3.0 oz aerosol part number 18-0070

Cylinder Spray Cleaner/Deicer: 3.0 oz aerosol part number 18-0435

Rosettes & Collars

Degree® Key System

SARGENT®

ASSA ABLOY

No. 1KB Rosette



- Used with 8200 Series mortise locks and No. 90 blocking rings when cylinders project from door
- Free spinning to protect cylinder from vandalism
- Consult 8200 series catalog for Rosette application details. Different collars required when used with exit devices. Consult Exits catalog for part numbers
- Furnished standard with 8200 Series sectional trim
- Cast brass, bronze or stainless steel
- 1-1/2" (38mm) diameter, includes compression spring
- Projection from door:

1KB-1	5/16" (8mm)
1KB-2	7/16" (11mm)
1KB-3	9/16" (14mm)
- Finishes: 3, 4, 9, 10, 10B, 10BE, 10BL, 15, 20D, 26, 26D

No. 97 Rosette



- Standard for cylinders ordered separately from hardware
- Standard for 4800 dead bolts and 7900 and 7800 Series mortise locks
- Brass, bronze or stainless steel
- 1-11/16" diameter (43mm), 9/32" (7mm) projection, includes compression spring
- Finishes: 3, 4, 9, 10, 10B, 10BE, 10BL, 15, 20D, 32, 32D

No. 90 Blocking Ring



- Used with 1KB-2 and 1KB-3 rosettes as spacer when mortise cylinder projects from face of door as shown above
- Consult 8200 series catalog for Blocking ring application details
- Brass, bronze or stainless steel
- 1-3/8" (35mm) diameter; available in thickness of 1/16", 1/8", 3/16", 1/4" and 3/8" projection in 1/16" (1.6mm) increments. Specify size when ordering.
- Finishes: 3, 4, 9, 10, 10B, 10BE, 10BL, 15, 20D, 26, 26D

Cylinder Nut Wrench



This wrench simplifies the installation and removal of mortise cylinders nuts used on 700 Series Auxiliary Control (80 Series ET Trim).

- Part number 97-0568

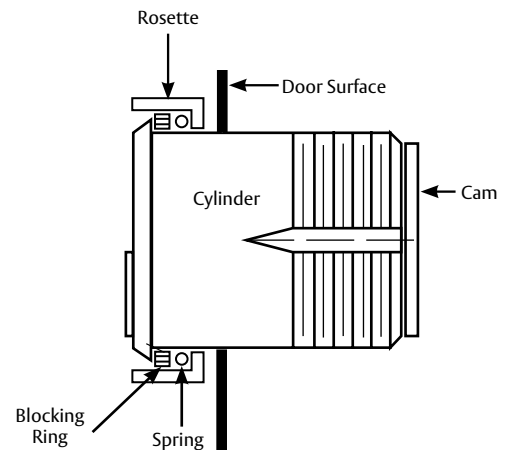

Crosscut illustration of rosette application

Copyright © 2011, 2014 -2017, Sargent Manufacturing Company, an ASSA ABLOY Group company. All rights reserved. Reproduction in whole or in part without the express written permission of Sargent Manufacturing Company is prohibited.

90705K 03/01/17

Visual Key Control Tamper Proof Packaging

Degree® Key System

SARGENT®
ASSA ABLOY

Visual Key Control (Stamping)

To allow for easier key and cylinder identification, SARGENT offers permanent stamping of keys and/or optional cylinder concealed stamping with industry standard alpha-numeric key set symbols.

All DG keys are stamped with key set symbol and “DO NOT DUPLICATE” as standard.

All DG master and control keys are stamped with the key set symbol and the key system register # cylinders as standard, (Item B) unless alternate stamping is requested on the order.

Master level keys do not include bitting numbers. Master level keys include system register numbers stamped on the first line and the standard visual key control designations on the second line (Item B).

Change keys have one line for up to 7 characters for key set stamping available for permanent Visual Key Control

- Key and cylinder identified by industry standard alpha-numeric keyset symbols
- Cylinder-slide stamping available on mortise, rim, LFIC and all bored cylinders except for 8-Line and 7600 (Items C, D, & E)
- Core side engraving available for 8-Line and 7600 (Item F)

Note: SARGENT will stamp alternate identity codes on cylinders and/or keys whenever requested. This alternate stamping can not be different if both are to be stamped. Master Level Keys can also be stamped with a single alternate code

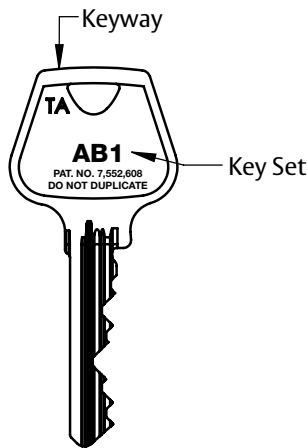

Item A
Change (Day)
Key Stamping

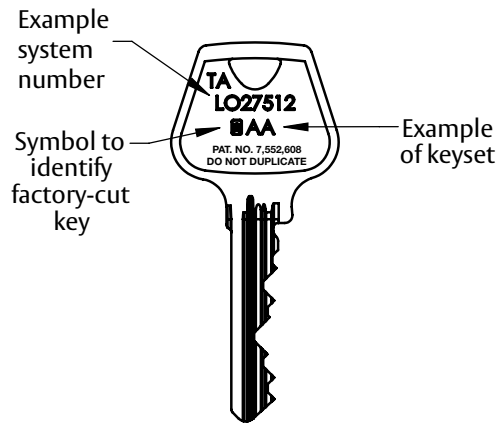

Item B
Master Level
Key Stamping

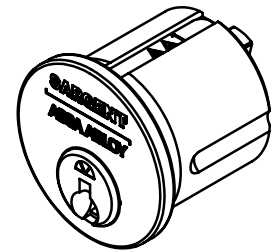

Item C

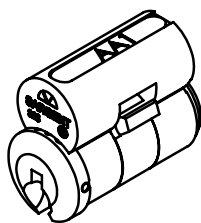

Item D

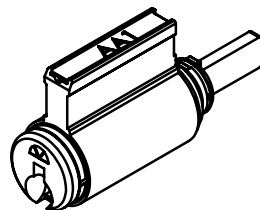

Item E

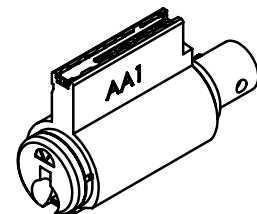

Item F

Tamper Proof Packaging

For the highest level of security for the end user, tamper proof packaging is used on all Degree master keys and key blanks. This heat sealed shrink wrap identified with “SARGENT Sealed For Your Security” provides assurance of the integrity of the factory generated key system.

Key Blanks/Key Sections

Degree® Key System



Master Key Blanks*	
DG1	DG 6270 TN
DG2- or DG3-	DS 6270 TN
DG1	DG 6270 TDH
DG2- or DG3-	DS 6270 TDH
DG1	DG 6270 THM
DG2- or DG3-	DS 6270 THM
DG1	DG 6270 TD
DG2- or DG3-	DS 6270 TD
DG1	DG 6270 TH
DG2- or DG3-	DS 6270 TH
DG1	DG 6270 TM
DG2- or DG3-	DS 6270 TM

Change Key Blanks*	
DG1	DG 6275 TA
DG2- or DG3-	DS 6275 TA
DG1	DG 6275 TB
DG2- or DG3-	DS 6275 TB
DG1	DG 6275 TC
DG2- or DG3-	DS 6275 TC
DG1	DG 6275 TE
DG2- or DG3-	DS 6275 TE
DG1	DG 6275 TF
DG2- or DG3-	DS 6275 TF
DG1	DG 6275 TG
DG2- or DG3-	DS 6275 TG
DG1	DG 6275 TJ
DG2- or DG3-	DS 6275 TJ
DG1	DG 6275 TK
DG2- or DG3-	DS 6275 TK
DG1	DG 6275 TL
DG2- or DG3-	DS 6275 TL

*Key blanks are made of Nickel Silver and sold in boxes of 50

Degree Cut Keys		
DG1	DG6272CMK	21-
DG1	DG6272CTL	6300s
DG1	DG6272MK	
DG1	DG6272CHK	
DG2 or DG3	DS6272CMK	21-
DG2 or DG3	DS6272CTL	6300s
DG2 or DG3	DS6272MK	
DG2 or DG3	DS6272CHK	

Emergency Master Keys		
DG1	DG6267EMK	bored locks
DG1	DG7268EMK	mortise locks
DG1	DG7269EMK	63- cylinders in mortise locks

Construction Keys		
DG1/DG2/DG3	6251CMK	64-
DG1/DG2/DG3	6251CTL	64-

For Multiplex Masterkey Systems (T keyway family shown)

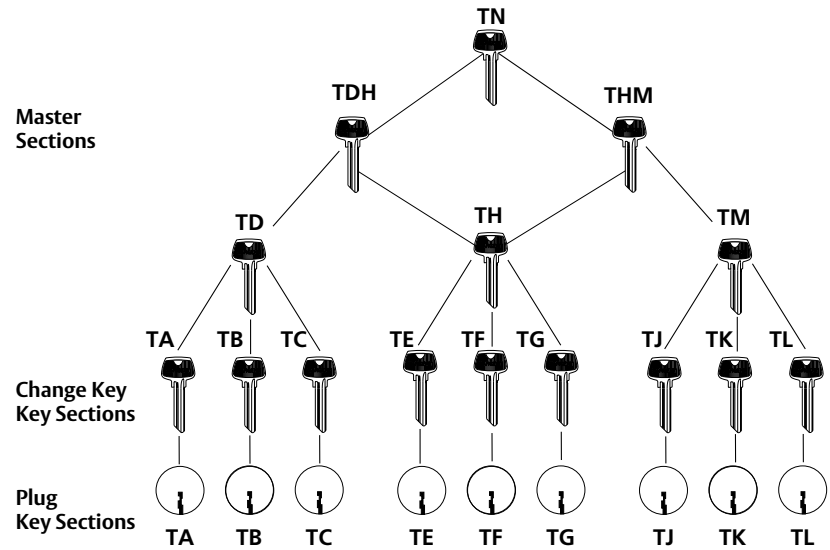

Legend:

- DG = DG1- keys only
- DS = DG2- & DG3- keys
- CMK = construction master key
- CTL = control key
- MK = master key
- CHK = change (day) key

Copyright © 2011, 2014-2017, Sargent Manufacturing Company, an ASSA ABLOY Group company. All rights reserved. Reproduction in whole or in part without the express written permission of Sargent Manufacturing Company is prohibited.

90705K 03/01/17

Master Keying & Cylinder Terms

Degree® Key System

SARGENT®

ASSA ABLOY

SARGENT requires all orders containing Master Keying details to be submitted using the industry standard Door and Hardware Institute (DHI) ANSI/BHMA format. Key symbols used on a master keyed order require combinations of letters and/or letters and numbers.

For complete details on proper structuring format of key symbols refer to: DHI Handbook, Section 8 - Finish Hardware, KEYING SYSTEMS AND NOMENCLATURE; ANSI/BHMA Standard A156.28, AMERICAN NATIONAL STANDARDS FOR KEYING SYSTEMS; or contact SARGENT for assistance at 1-800-727-5477.

Basic Keying Terms

Keys and terms	Abbreviation	Definition
Change key	CK	Individual lock key
Masterkey	MK	Operates any given quantity of cylinders with different key changes
Grand Masterkey	GMK	Operates all individual locks already operated by masterkey(s)
Great Grand Masterkey	GGMK	Operates all locks under the various masterkey(s) and grand master key(s) already established
Emergency Key	EMK	Operates hotel locks having shut out feature which blocks entry by all other keys
Construction Key	CMK	Operates all cylinders designated for a temporary period during construction
Control Key	CTL	Key to install or remove interchangeable or removable cores
Keyway	KWY	Broaching in a cylinder plug
Key Section	KWY	Sidewarding on key to match broaching in plug
Single Keyed	SKD	Cylinders operated by their change key only; not operated by any master key

Examples of Master Key System Levels and Symbol Structure**

Level 2

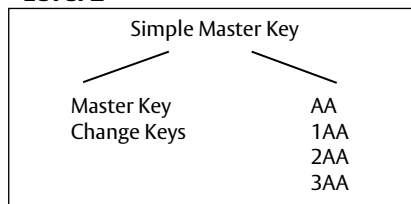

Level 3

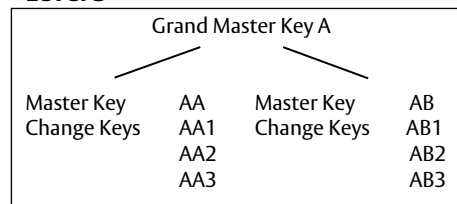

Level 4

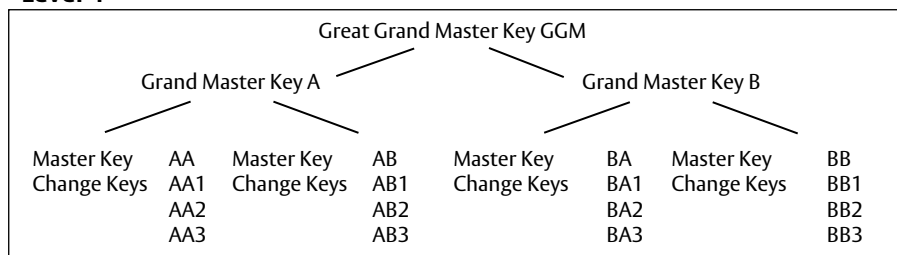

**Master key system levels greater than Level 4 are not recommended. Contact SARGENT key records for additional information

Construction Master Keying (21- Option)

Degree® Key System

SARGENT®
ASSA ABLOY

Construction Master Keying (Lost/Wafer Design) for DG1-, DG2- & DG3-

SARGENT Degree cylinders when master keyed are offered with the convenience of construction keying when specified with the 21- option. This is not recommended with DG3 key systems or any system where strict key control and management is enforced.

Construction keying simplifies the process when the building gets turned over. With this feature, the 21- cylinder is master keyed with a special construction feature in one of the chambers. The plug is prepped in two places along both sides of the same chamber containing the construction feature. This allows the construction master key to be used during the construction phases.

It is highly recommended that all construction keys are collected and accounted for once the project is complete to protect the integrity of the key system. This is not recommended with DG3 key systems or any system where strict key control and management is enforced.

New systems supplied with 6 construction master keys unless otherwise specified. Orders to existing key systems that require additional construction keys are to be specified and ordered separately.

Orders with 21- will have all change keys shipped separately from hardware. Six construction master keys provided per system unless otherwise specified.

The 21- is not available with hotel function cylinders or large format interchangeable cores (6300 series). If construction keying is required for LFIC, specify 64-DG- construction keyed cores.

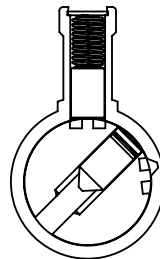
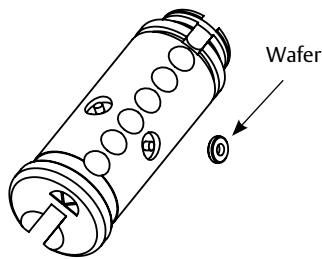

Cutaway cylinder showing construction master key being used, putting the wafer below the shear line while key is turned. Note the two empty "donut" holes on either side of the chamber.

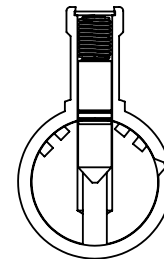

Change key inserted in cylinder putting the wafer at the shear line.

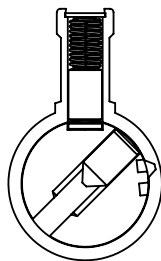

As change key rotates, construction wafer falls into "donut" hole in the side of plug. Only construction wafer will fall due to hole through its center.

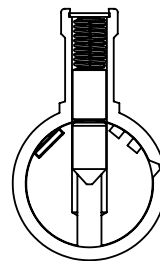

Change key rotated to position for extraction.

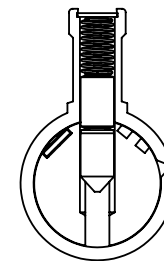

Construction key inserted after wafer is trapped. Driver now extends into plug chamber. Construction key if used will not rotate.

Copyright © 2011, 2014-2017, Sargent Manufacturing Company, an ASSA ABLOY Group company. All rights reserved. Reproduction in whole or in part without the express written permission of Sargent Manufacturing Company is prohibited.

90705K 03/01/17



SARGENT'S KeyWizard™ 5.5 Software Package Tracks Multiple Key Systems Including Keys, Keyholders, Locations, and Hardware Information

This comprehensive key management software package was developed for locksmiths and end-users to track detailed information.

The program features easy to navigate, non-cluttered screens and uses a format similar to Microsoft® Outlook™.

Features:

- Free Technical Support at 1-800-610-1706 and system upgrades for 1 year
- Website support at www.keywizard.net
- Multi-level passwords and access levels
- Clear, easy to read screens
- Manages multiple end user key systems
- Customized query, reporting and search capability
- Global searching across multiple key systems
- Comprehensive hardware schedules
- Keyholder photos and signatures for identity verification
- Scheduled maintenance and reminders for overdue keys and back-ups
- Accurate key symbol sorting
- Multi-level key authorizations and key deposits
- Network and stand-alone versions
- Pinning calculators
- Reports options including printing in a variety of formats and e-mail
- Cylinder and key random serial ID generator
- Key authorization forms that can be printed at will
- Editable field titles
- Ability to connect to a website and search for any updates

How to order for new users:

- Single License Version — KW-SS1
- Network Version — KW-SSN1
- Demonstration Version — KW-DEMO1

How to order, if upgrading from KeyMinder*:

- Single License Version — UP-KW-SS1
- Network Version — UP-KW-SSN1

*consult factory for eligibility requirements

Keying Data

Keying data (key sets and bittings) is available for order with new or existing systems to eliminate the need for manual data entry into Key Wizard. Place order based on size of system.

Part Number	Description
DLKW1	1 to 50 bittings
DLKW2	51 to 200 bittings
DLKW3	201 to 1000 bittings
DLKW4	1001-3000 bittings
DLKW5	3001-6000 bittings
DLKW6	6001-9000 bittings
DLKW7	Over 9000 bittings

Computer System Recommendations:

REQUIRED:

- 350 MHz processor
- 60 MB hard disk space
- Windows® 7, Vista, XP, NT, ME, 2000 or 98
- 64MB Ram
- CD drive

RECOMMENDED For Better Performance:

- 500 MHz or faster
- 70 MB or more
- Windows® 7, Vista, XP, NT, ME, 2000 or 98
- 64MB Ram
- CD drive

BITTING LISTS

Paper bitting lists provided at no charge for factory corresponding keyed orders when requested at time of hardware order. An owners letter of authorization must be attached to all purchase orders. Existing key system bittings lists are also available contact key records for more information.

Part 1 – General

Keying Schedule—

- The keying schedule is just as important as the hardware schedule
- The key meeting requirements

Who attends

Example: “Upon approval of the finish hardware schedule meet with the owner’s representative to determine the project’s keying requirements. In attendance shall be a Certified Key System Specialist.”

Administrative documents should be reviewed and executed at this meeting.

Delivery, Storage and Handling—

- The delivery and storage of the permanent cylinders, cores, keys, key control software

Extra Material—

- Consideration should be given to include additional permanent cylinders, key blanks and key cutting equipment, etc

Part 2 – Product

Keying: (SARGENT Degree)—

All cylinders shall be SARGENT Degree. Provide utility patented cylinders that require the use of a patented controlled key. Provide bump resistant fixed core mortise and rim cylinders standard. Except where otherwise specified all locksets, exit devices and cylinders shall be of the same manufacturer. Provide recessed cylinder collars for all mortise and rim cylinders. Establish a new multilevel factory designed secured master key system for this project that will meet the owners requirements for this project and future expansion. All keying shall be done at the factory where permanent records will be established and maintained. Manufacturer to have a minimum of 10 years experience designing secured master key systems and have a published security policy.

Provide a 6 pin multilevel master key system which is comprised of patented controlled keys, security and high security cylinders that can all be operated by ONE key of the highest level. Geographical exclusivity shall be provided for all security and high security cylinders. Provide certified cylinders meeting ANSI/BHMA A156.5-2010 Grade 1. Provide mortise, rim and key-in-lever cylinders certified to UL437 where specified.

Provide construction master keying for all fixed core cylinders. Provide temporary keyed cores for all large formatted interchangeable core cylinders. Permanent keys and cores are to be delivered directly to the owner or owner’s representative. Provide nickel silver keys with industry standard Visual Key Control stamping on the bow only for each permanent cut key. Furnish keys in the following quantities.

- 1 each top master key for the system(s)
- 4 each Change keys per cylinder or 10 keys per keyed alike group
- 2 each Control keys (if required)
- 2 each Master keys per master key group and/or selective master key
- 2 each Construction control keys (if required)
- 12 each Construction keys
- Provide 1 copy of bitting list to the owner

Where specified DG1; provide utility patented controlled keyway cylinders that are furnished with patented keys that are only available from authorized distribution. Provide bump resistant fixed core mortise and rim cylinders standard. Where specified DG2; provide utility patented controlled keyway and side bar locking incorporating unique angled bottom pins that provide end users with geographical exclusivity. Cylinders shall be constructed to provide protection against bumping and picking. Where specified DG3; provide utility patented controlled keyway and side bar locking incorporating unique angled bottom pins that provide end users with geographical exclusivity. Cylinders shall be constructed to provide protection against bumping, picking and drilling. Provide mortise, rim and key-in-lever cylinders certified to UL437.

Specified manufacturer Sargent Degree Key Control

- Specify Key Wizard software

Part 3 – Execution

Care should be taken to identify the required process of turning over a patented locking system to the owner.

Degree DG1 Required Administrative Documents:

- **Mandatory:** all new systems will require a completed System Information Document (orders cannot be entered without this document). The fully executed original document will be kept on file at Sargent Manufacturing
- **Subsequent order requirements:** A letter of authorization will be required if the product is shipped to an address other than what's recorded on the System Information Document and/or if the address on the purchase order is different than what is listed on the System Information Document

Degree DG2 & DG3 Required Administrative Documents:

- **Mandatory:** all new systems will require a completed System Information Document (orders cannot be entered without this document). The fully executed original document will be kept on file at Sargent Manufacturing
- **Subsequent order requirements:** A specific randomized security code will be required for each order unless "Opt-Out" has been authorized by the systems administrator
- If the "Opt Out" option is **NOT** selected
 - A correct system specific (randomized) security code must be included with each subsequent order
 - Security codes are specific to each order
 - If the shipping address is other than the one listed on the System Information Document, a Letter of Authorization signed by one of the recorded authorized representatives of the facility and an authorized security code must accompany the order
 - Letter of Authorization must contain the same shipping address that appears on the customer's purchase order
 - Letter of Authorization will not be kept on file at factory
 - Without the proper security code, Letter of Authorization, or if the shipping address is other than what is listed on the System Information Document, the order cannot be processed

The System Administrator may elect not to use security codes as part of the authorization process by selecting the "Opt Out" option.

- If the "Opt Out" option **IS** selected
 - If the shipping address is other than the one listed on the System Information Document, a Letter of Authorization signed by one of the recorded authorized representatives of the facility must accompany the order
 - Letter of Authorization must be signed by one of the facility's authorized representatives
 - Letter of Authorization must contain the same shipping address that appears on the customer's purchase order
 - Letter of Authorization will not be kept on file at factory

Degree® System Information Document

Degree® Key System



System: _____ DG1
_____ DG2 / DG3

Note: Degree SID is required with every initial order

Facility Name _____

Mailing Address: _____ Shipping Address: _____

City: _____ State: _____ City: _____ State: _____

Zip Code: _____ Zip Code: _____

Phone: (_____) _____

Fax: (_____) _____

E-Mail: _____

By: _____
(Print Name, Primary Systems Administrator) (Title) (Authorized Signatures)

I understand that if any of the authorized representatives of this Facility (as listed below) are removed from their duties for any reason whatsoever, it is my responsibility to notify SARGENT Key Records Department, in writing, of their release and the names of their replacements.

Date: _____

Authorized Facility Representatives

(Print Name)	(Title)	(Authorized Signatures)
_____	_____	_____
_____	_____	_____
_____	_____	_____

Please attach any additional Authorized Facility Representatives.

“ OPT-OUT” Option (System Type DG2 & DG3 Only): By selecting this option I elect not to use the sequentially numbered registration certificates and agree to substitute them with a Letter of Authorization.

Signature or initials required by System Administrator when selecting to “Opt-Out”.

Note: Use this form along with the keying cover sheets found in the general information section of the price book

Copyright © 2011, 2014-2017, Sargent Manufacturing Company, an ASSA ABLOY Group company. All rights reserved. Reproduction in whole or in part without the express written permission of Sargent Manufacturing Company is prohibited.

90705K 03/01/17

SARGENT Manufacturing Company
100 Sargent Drive
New Haven, CT 06511 USA
800-727-5477
www.sargentlock.com

ASSA ABLOY is the global
leader in door opening solutions,
dedicated to satisfying
end-user needs for security,
safety and convenience

Founded in the early 1800s, SARGENT® is a market leader in locksets, cylinders, door closers, exit devices, electro-mechanical products and access control systems for new construction, renovation, and replacement applications. The company's customer base includes commercial construction, institutional, and industrial markets.

Copyright © 2011, 2014-2017, Sargent Manufacturing Company, an ASSA ABLOY Group company. All rights reserved. Reproduction in whole or in part without the express written permission of Sargent Manufacturing Company is prohibited. Patent pending and/or patent www.assaabloydss.com/patents.